

FULL SECTION THROUGH KERB 1:6

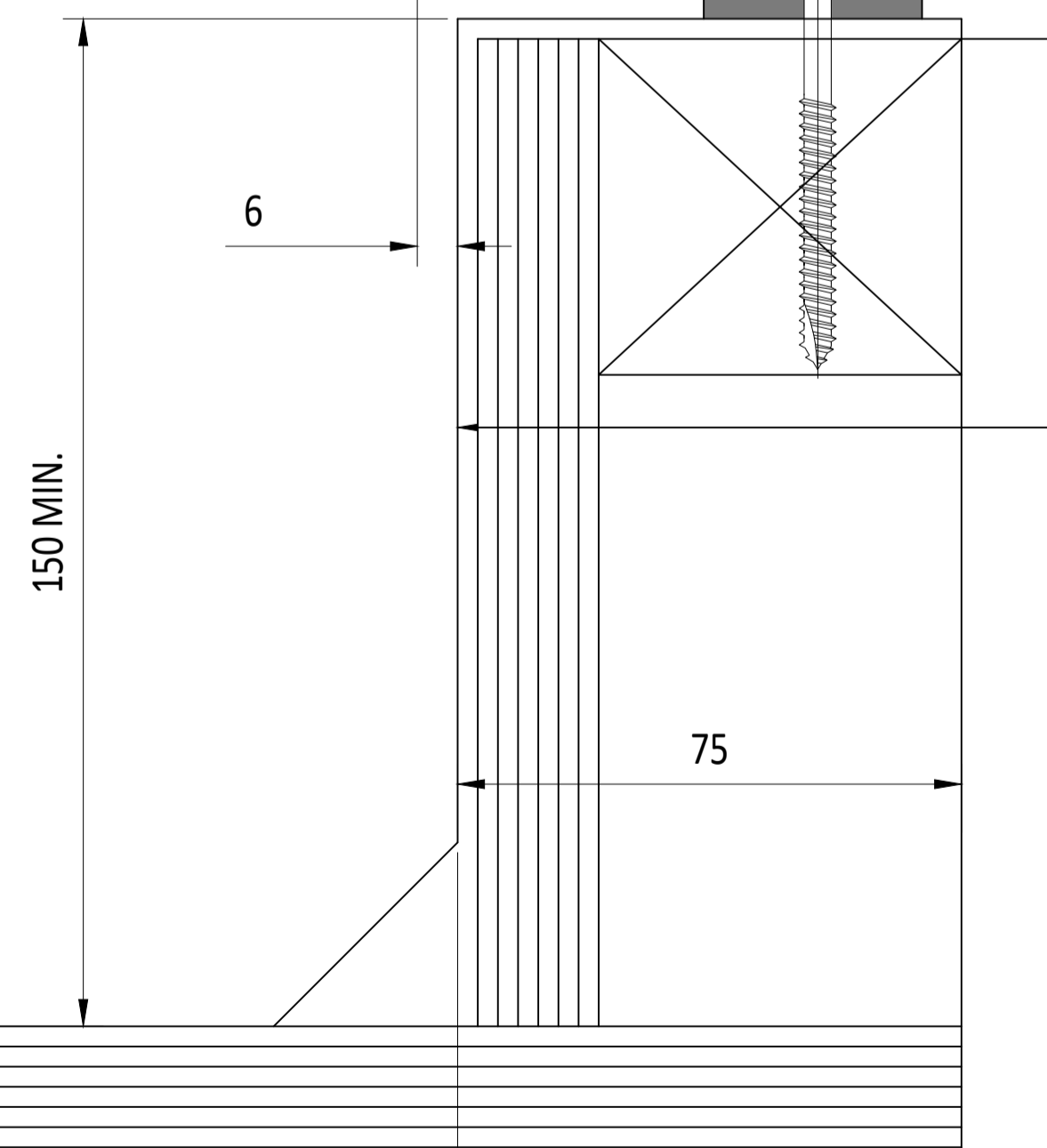

ROOFLIGHT ORDER SIZE -12 = EXTERNAL KERB SIZE

KERB SECTION DETAIL 1:1

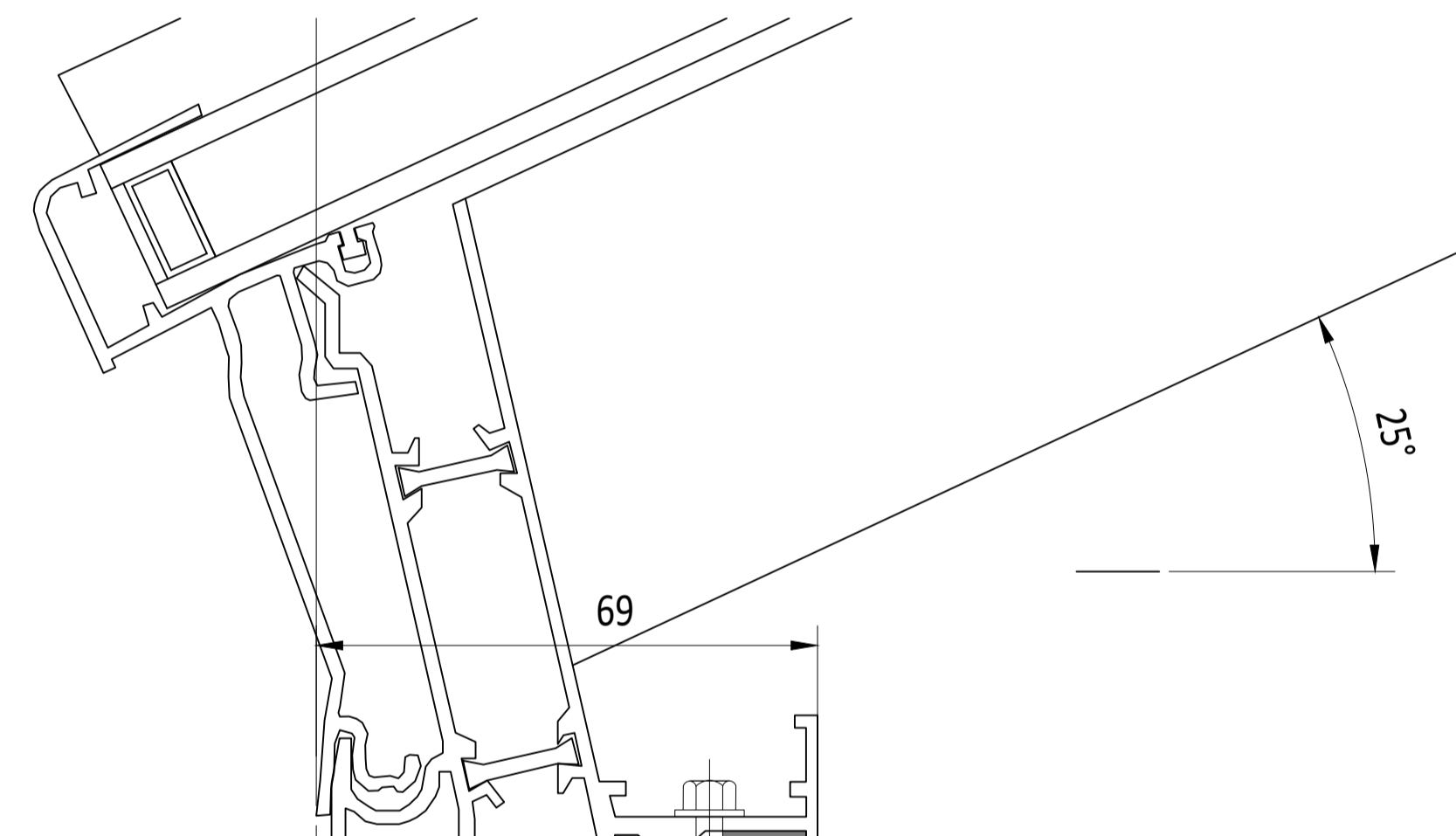
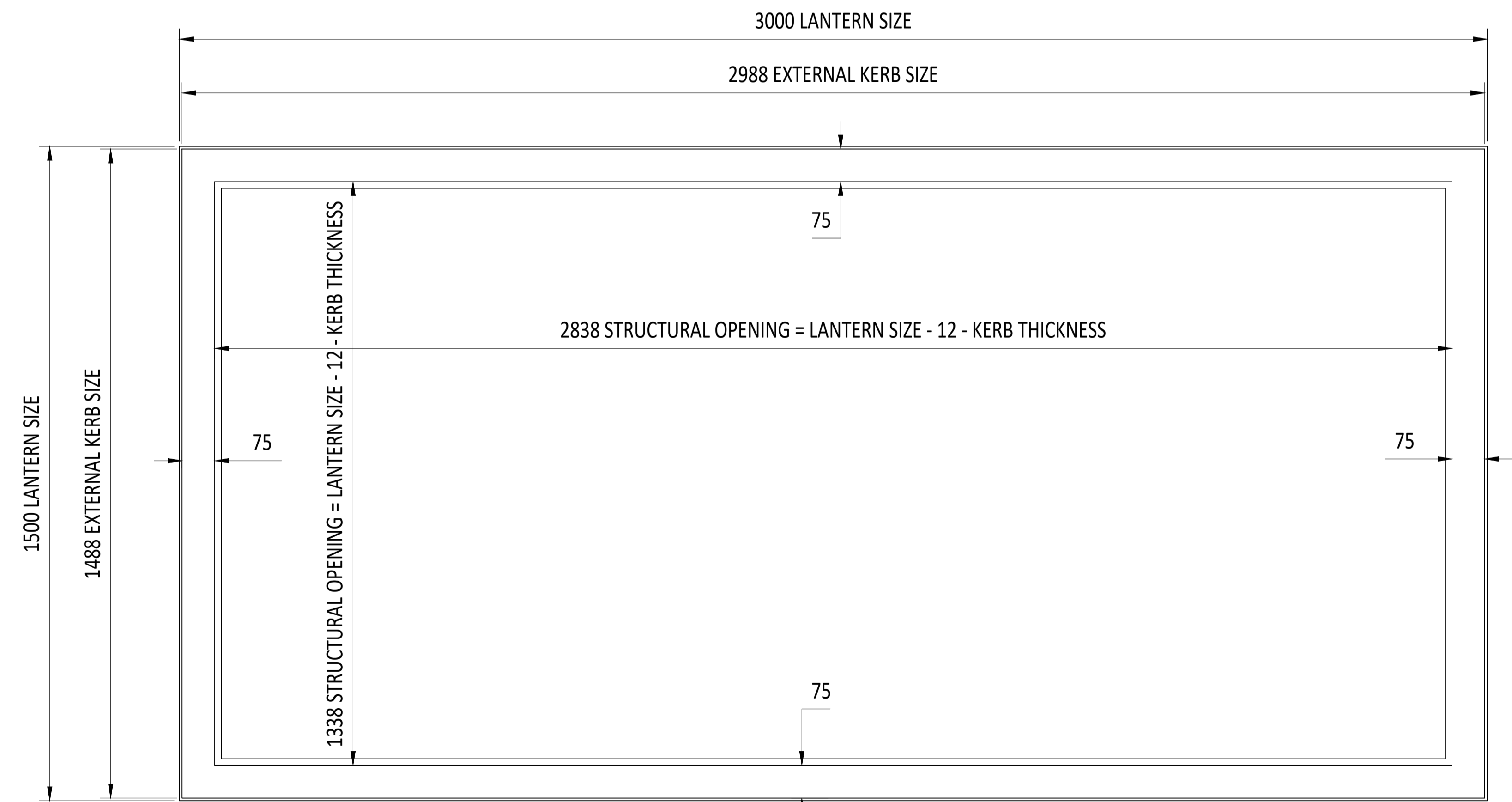

PLAN ON KERB 1:8

IF IN DOUBT ASK DO NOT SCALE



IT IS THE RESPONSIBILITY OF THE KERB DESIGNER TO ENSURE THE KERB WILL BE STRUCTURALLY ADEQUATE TO HOLD THE ROOFLIGHT. KERBS SHOWN ON THESE DRAWINGS ARE FOR ILLUSTRATION PURPOSES ONLY.

The manufacturer would advise an installation with a minimum pitch of 5° for rooflight units to minimize water pooling. Whilst the product can be installed flat without detriment to the warranty, the manufacturer cannot be held responsible for any excessive pooling of water to the surface of the rooflight, post installation, if installed without an adequate fall, larger units may require a greater fall. The final decision on amount of fall required must be made by the client and relayed to the installer.

THIS DRAWING MUST NOT BE COPIED OR PASSED TO A THIRD PARTY WITHOUT WRITTEN CONSENT FROM THE MANUFACTURER.

CHECKED S. RICHARDS  
DATE 02-07-2021  
DRAWN D. PUGH  
DATE 02-07-2021

TOLERANCE UNLESS OTHERWISE STATED ±1.5  
DIMENSIONS IN MM  
SCALE AS SHOWN @ A1

MATERIAL  
FINISH

REV	AMENDMENTS	SIGNED	CHECKED	DATE

Roofglaze Rooflights Ltd.  
11 Howard Road, Eaton Socon,  
St Neots, Cambs, PE19 8ET  
Telephone 01480 474797

DRAWING N°. RGR-K-D-01

TITLE: KORNICHE LANTERN KERB DETAILS

REV  
SIZE  
A1

**ROOFGLAZE**  
Lighting by nature™