

**1** 00 GF Panels  
Scale @ 1:10

**Timber Kerb Dimensions**

External Weathered		External Unweathered		Internal Size / Opening	
900	1200	880	1180	736	1036
1000	1000	980	980	836	836
1000	1500	980	1480	836	1336
1000	2000	980	1980	836	1836
1000	3000	980	2980	836	2836

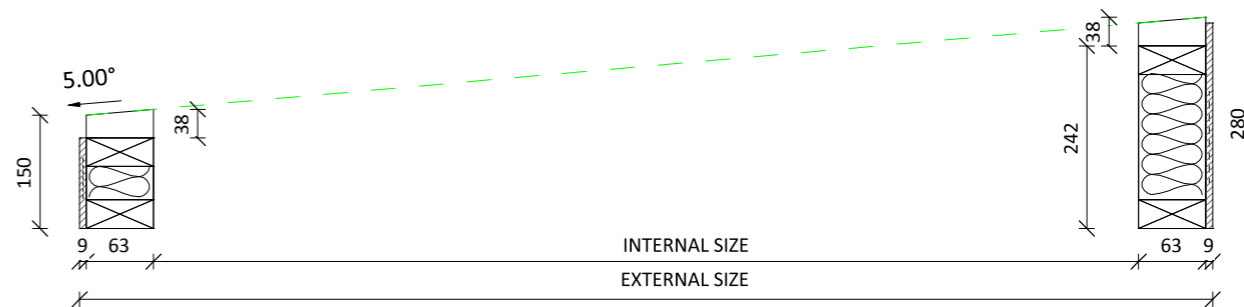

**2** Section 1  
Scale @ 1:10

**Standard Stock Timber Kerb Sizes\***

- 900mm x 1200mm
  - 1000mm x 1000mm
  - 1000mm x 1500mm
  - 1000mm x 2000mm
  - 1000mm x 3000mm
- \*All stock timber kerbs are approx. 72mm thick

**Timber Kerb Specifications**

- Timber Studs: 38mm x 63mm CLS C16 @ 600mm c/c
- Ply Thickness: 9mm Marine Grade
- Insulation Thickness: 70mm
- Insulation Weight: 1.55kg/m<sup>2</sup>
- CE Marked



**3** 3D Framing View

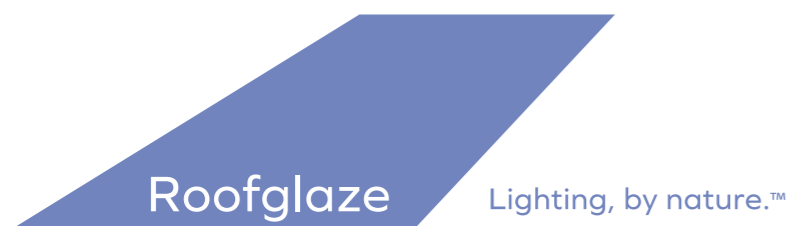

Tel: 01480 474 797  
E-mail: [rgrestimating@roofglaze.co.uk](mailto:rgrestimating@roofglaze.co.uk)  
Web: [www.roofglaze.co.uk](http://www.roofglaze.co.uk)

Timber Kerbs for Stock  
Flatglass Rooflights

**Roofglaze Rooflights Ltd**  
11 Howard Road  
Eaton Socon  
St Neots  
Cambridgeshire PE19 8ET