

**NOTES**

X No. REQUIRED

GLASS SPEC:  
 OUTER : 6mm CLEAR HST TOUGHENED GLASS  
 CAVITY : 16mm ARGON FILLED + WARM EDGE SPACER  
 INNER : 6mm CLEAR HST TOUGHENED OR 8.8mm LAMINATED GLASS + LOW E COATING  
 SILICONE BONDED

- LIGHT TRANSMISSION = 78 %
- CENTRE PANE U VALUE = 1.1 W/M<sup>2</sup>.K
- SOLAR G VALUE = 0.63
- ACOUSTIC REDUCTION = 34 (6/6) 39 (6/8.8) RW DB
- AIR PERMEABILITY = CWCT CLASS A4
- WEATHER RESISTANCE = CWCT CLASS A7
- WIND RESISTANCE = CWCT CLASS E2400
- AA FIRE-RATED: AA DESIGNATION (NATIONAL CLASS) OR BROOF (T4) EUROPEAN CLASS AND EURO CLASS A1 NON-COMBUSTIBLE
- WEIGHT = 45 KG/M<sup>2</sup> PER PANEL/ SECTION (SIZE DEPENDENT)

INTERNAL OPENING SIZE IS NOT RELEVANT EXCEPT TO COMPLETE GLAZING BAR DESIGN.

GLASS BONDED TO FRAME WITH GLAZING SECURITY TAPE. KERB DETAILS SHOWN INDICATIVE DETAILED DESIGN BY OTHERS.

MIN. 5° FALL RECOMMENDED TO HELP SHED WATER. LARGER UNITS MAY REQUIRE STEEPER PITCHES.

PRODUCT U-VALUE = AS LOW AS 1.2 W/m<sup>2</sup>.K (SIZE DEPENDENT)

MAX DOWN SLOPE = 3.2m. OVER 2m STEEL REQUIRED TO GLAZING BARS. OVER 3.2m SPECIAL DESIGN REQUIRED.

DESIGN LOADS: 750N/m<sup>2</sup> WIND 640N/m<sup>2</sup> SNOW AS STANDARD. OTHER LOADS TO BE SPECIFIED BY CLIENT.

SILICONE **MUST** BE APPLIED TO TOP OF GLAZING BARS AS WELL AS BETWEEN GLASS IGU'S. A FULL SEAL MUST BE ACHIEVED. ELECTRICAL INSTALL BY OTHERS.

BACK TO BACK ANGLE GLAZING BAR SHOWN. ALL BAR TYPES ARE ROOFLIGHT SIZE DEPENDANT. SEE DWG: RG-80-20-20Z FOR TYPES. uPVC SHROUD ONLY AVAILABLE WITH INTERLOCKING GLAZING BAR.

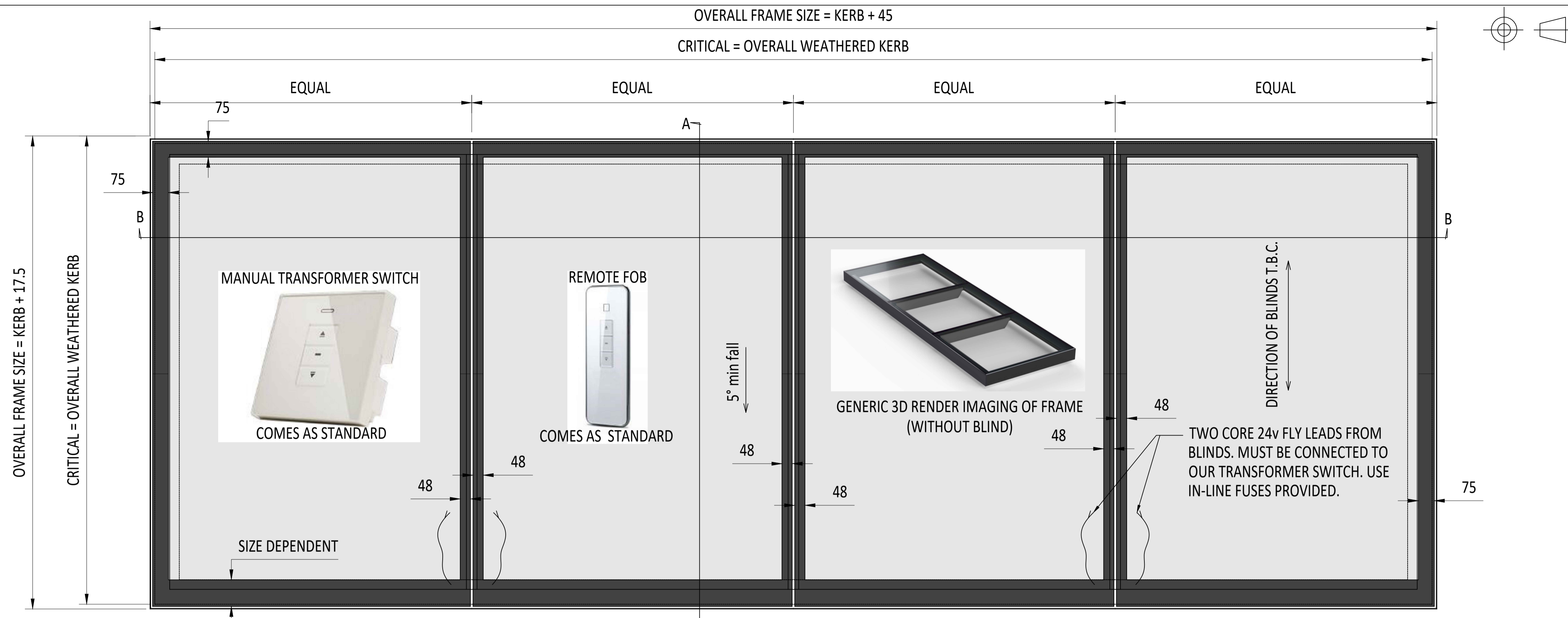

EXTERNAL PLAN VIEW TRUE VIEW ON SLOPE

MULTI BLIND OPERATION AVAILABLE AS AN UPGRADE OPTION

BLIND MUST RUN ALONG THE LONG LENGTH ONLY UNLESS UNIT IS SQUARE

NOTE:  
 GLAZING BAR DESIGN IS DEPENDANT UPON A NUMBER OF FACTORS; GLASS STRENGTH, GLASS WEIGHT, KERB SPAN, DESIGN LOADS, AND BAY CENTRES. INTERLOCKING GLAZING BARS WILL NOT BE AVAILABLE AT EVERY SIZE OF ROOFLIGHT. ASK RGR TECHNICAL FOR THE GLAZING BAR TYPE FOR YOUR ROOFLIGHT DESIGN. IF THE INTERLOCKING BAR IS NOT AVAILABLE, NOR IS A COVER SHROUD. BACK TO BACK ANGLES SHOWN. NO COVER SHROUD IS AVAILABLE FOR THESE BAR TYPES.

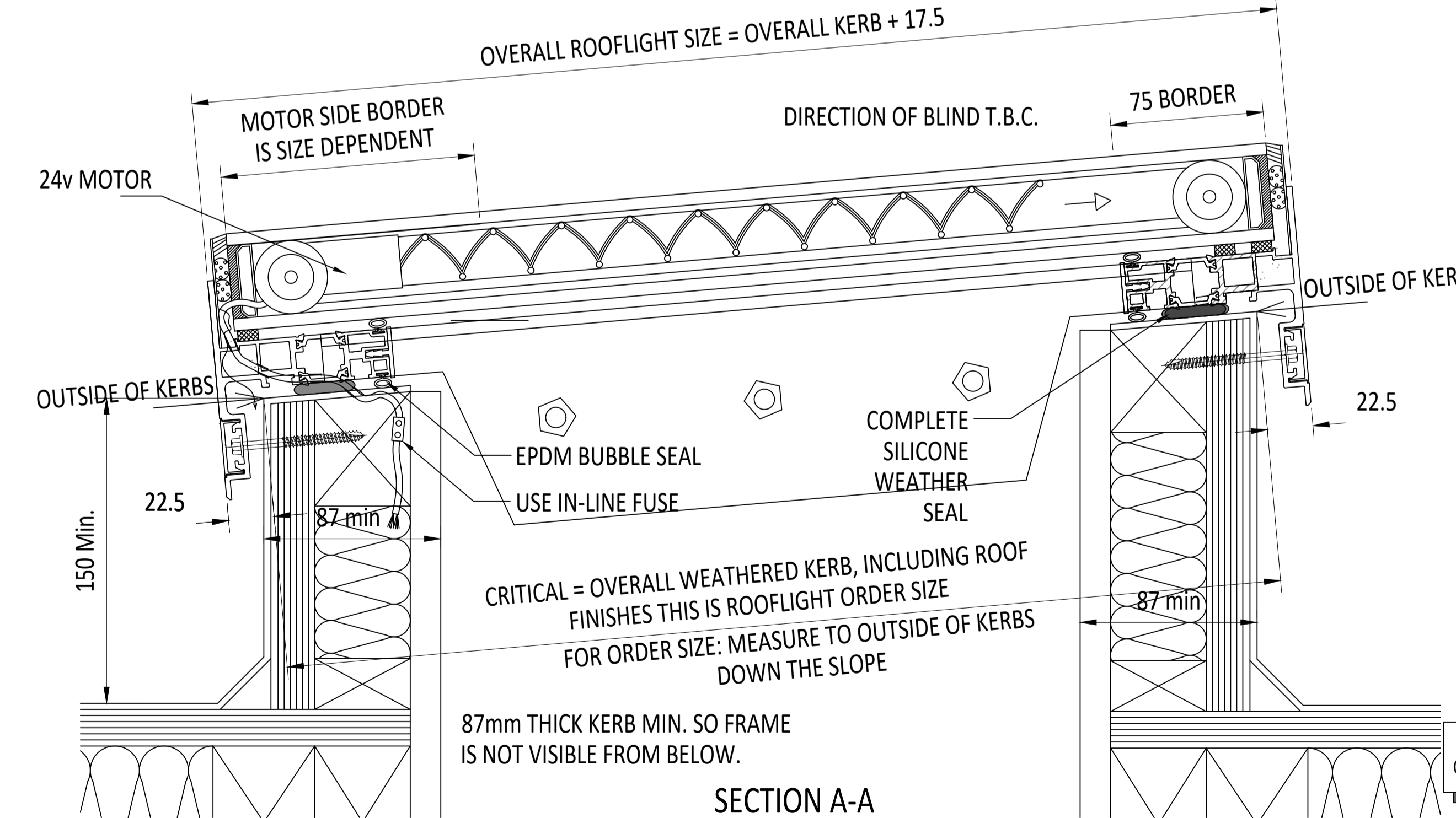

SECTION A-A

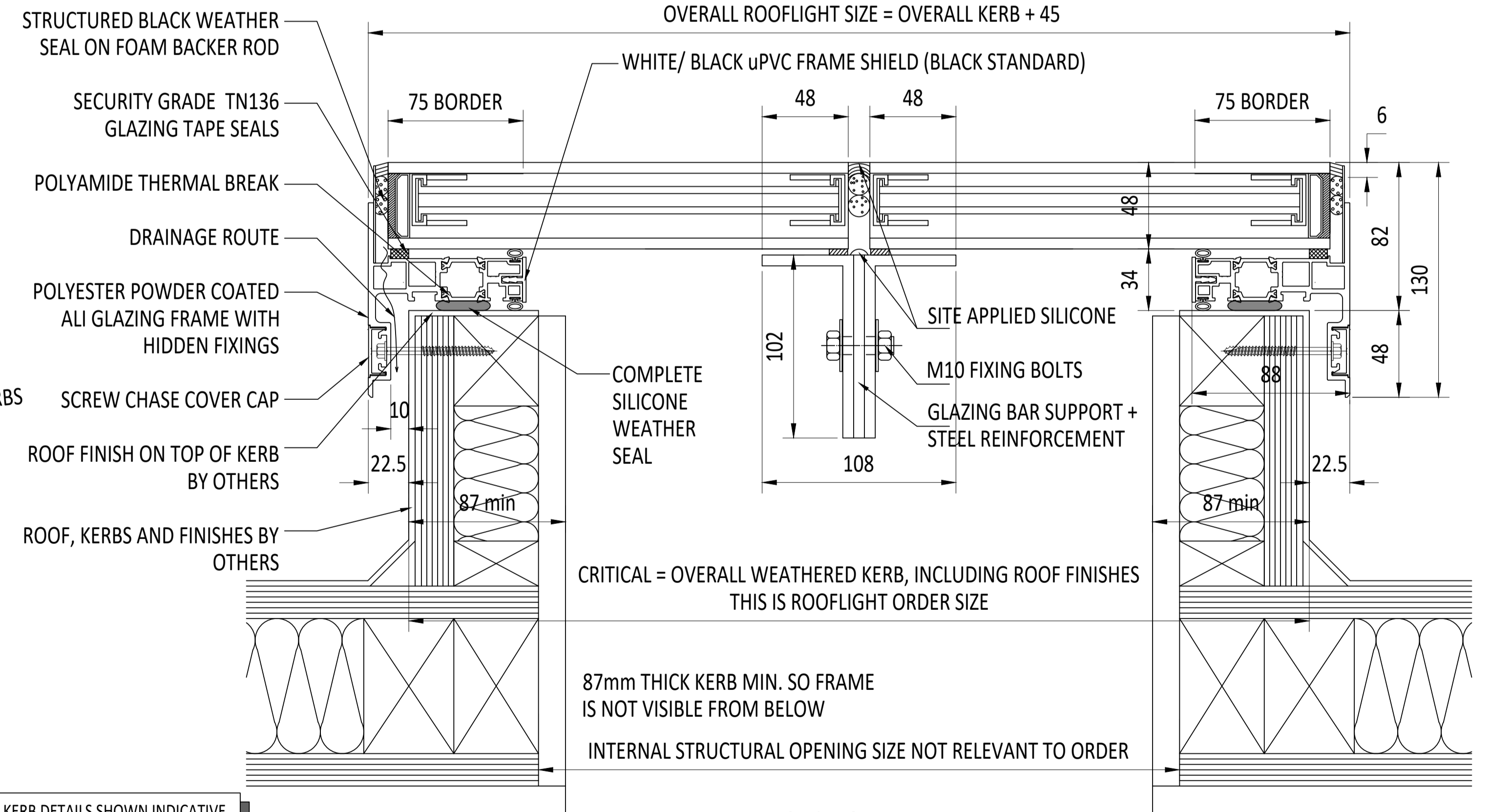

SECTION B-B

KERB DETAILS SHOWN INDICATIVE ONLY. DETAILED DESIGN BY OTHERS

<p>IF IN DOUBT ASK DO NOT SCALE</p>	<p>IT IS THE RESPONSIBILITY OF THE KERB DESIGNER TO ENSURE THE KERB WILL BE STRUCTURALLY ADEQUATE TO HOLD THE ROOFLIGHT. KERBS SHOWN ON THESE DRAWINGS ARE FOR ILLUSTRATION PURPOSES ONLY.</p>	<p>The manufacturer would advise an installation with a minimum pitch of 5° for rooflight units to minimize water pooling. Whilst the product can be installed flat without detriment to the warranty, the manufacturer cannot be held responsible for any excessive pooling of water to the surface of the rooflight, post installation, if installed without an adequate fall. Larger units may require a greater fall. The final decision on amount of fall required must be made by the client and relayed to the installer.</p>	<p>THIS DRAWING MUST NOT BE COPIED OR PASSED TO A THIRD PARTY WITHOUT WRITTEN CONSENT FROM THE MANUFACTURER.</p>	<p>CHECKED A. PHILLIPS</p>	<p>TOLERANCE UNLESS OTHERWISE STATED ±5</p>	<p>MATERIAL ALUMINIUM + GLASS</p>	<p>FINISH STANDARD POLYESTER POWDER COAT OPTIONS: RAL 7016 ANTHRACITE GREY, RAL 9005 BLACK, RAL 9010 WHITE, 30% GLOSS (MATT)</p>	<p>REV AMENDMENTS</p>	<p>SIGNED</p>	<p>CHECKED</p>	<p>DATE</p>	<p>Roofglaze Rooflights Ltd.                  11 Howard Road, Eaton Socon,                  St Neots, Cambs, PE19 8ET                  Telephone 01480 474797</p>	<p>DRAWING N°: RGR-MP-20-214</p>	<p>REV ROOFLAZE</p>
				<p>DATE 30-07-2020</p>										